

# СТОЛ ДЛЯ ПИЦЦЫ ТАТРА TPZEN3 STB КАМЕННАЯ СТОЛЕШНИЦА

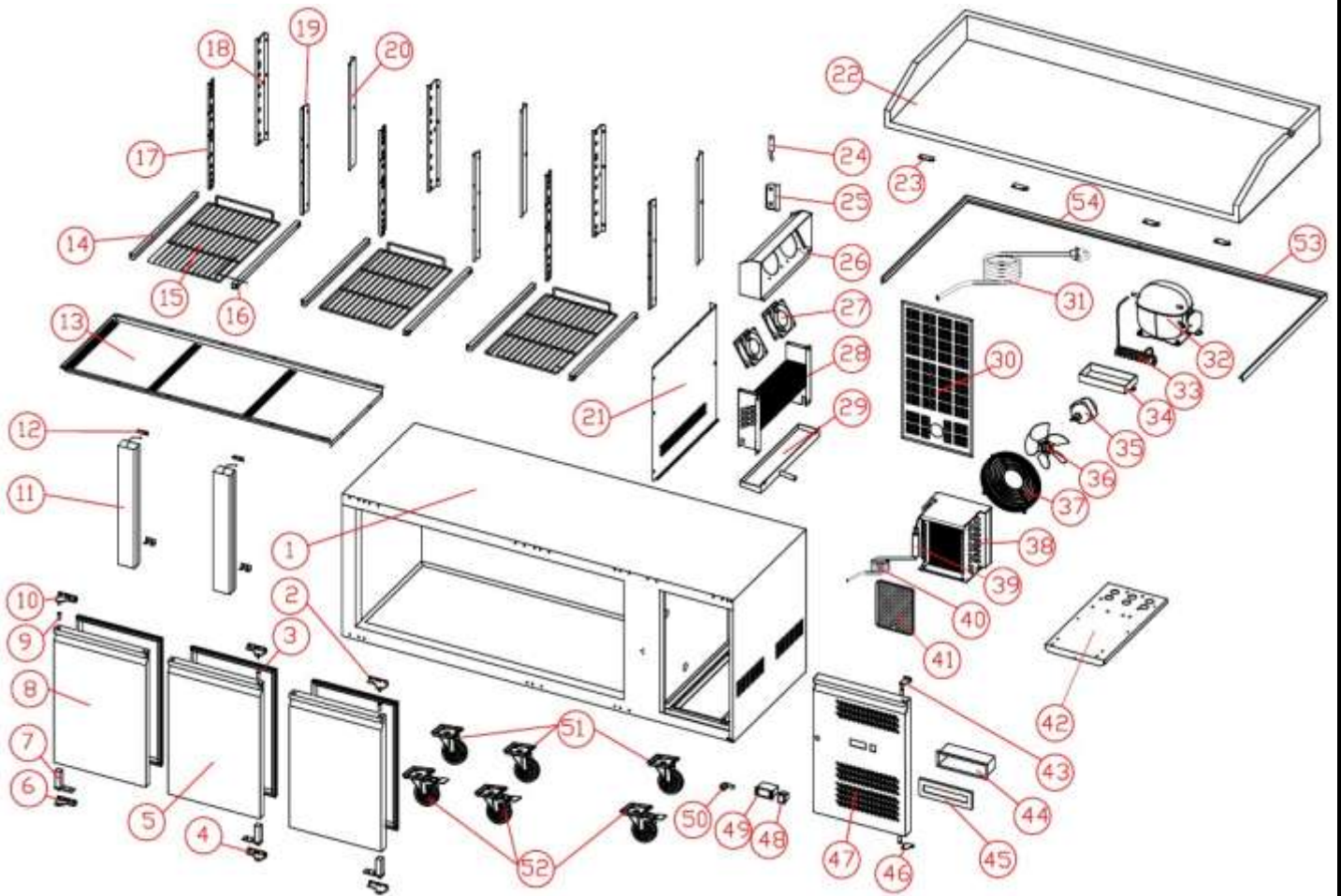

## СТОЛ ДЛЯ ПИЦЦЫ ТАТРА TPZEN3 STB КАМЕННАЯ СТОЛЕШНИЦА

1	CABINET	GXE-0-000-0058-0	1
2	RIGHT UPPER HINGE	GXE-2-001-0022-0	1
3	DOOR GASKET	16401000222	2
4	RIGHT BOTTOM HINGE	GXE-2-001-0024-0	1
5	DOOR(RIGHT )	GXE-0-000-0112-0	1
6	LEFT BOTTOM HINGE	GXE-2-001-0023-0	1
7	SPRING HINGE	12517240002	2
8	DOOR(LEFT )	GXE-0-000-0111-0	1
9	DOOR AXIS SLEEVE	16353010008	4
10	LEFT UPPER HINGE	GXE-2-001-0021-0	1
11	MIDDLE BEAM	GXE-0-000-0083-0	2
12	MIDDLE BEAM CONNECT	GXE-2-001-0017-0	4
13	AIR GUIDE BOARD	GXE-2-001-0213-0	1
14	LEFT SHELF GUIDE	GXE-2-001-0216-0	2
15	SHELF	12502012883	2
16	RIGHT SHELF GUIDE	GXE-2-001-0215-0	2
17	BEAM HANG STRIP(LEFT)	GXE-2-001-0032-0	2
18	REAR HANG STRIP(LEFT)	GXE-2-001-0034-0	2
19	BEAM HANG STRIP(RIGHT)	GXE-2-001-0031-0	2
20	REAR HANG STRIP(RIGHT)	GXE-2-001-0033-0	2
21	FAN COVER	GXE-2-001-0214-0	1
22	STONE	38601802020	1
23	TOP FIXING PLATE	GXE-2-001-0020-0	3
24	PROBE	17649490013	1
25	PROBE COVER	GXE-2-001-0286-0	1
26	EVA. FAN COVER	16358010001	1
27	EVA. FAN	17701151238	2
28	EVAPORATOR	17404040470	1
29	EVAPORATOR DRAIN PAN	16316130003	1
30	BACK COVER	GXE-2-001-0035-0	1
31	POWER CORD	17664640059	1
32	COMPRESSOR	17209010074	1
33	HIGH PRESSURE PIPE	17116060009	1
34	OUTER DRAIN PAN	16316130004	1
35	COND. FAN MOTOR	22752520010	1
36	COND. FAN BLADE	16381738082	1
37	COND.FAN COVER	22726010002	1
38	CONDENSER	17303090180	1
39	DRYER FILTER	17303090230	1
40	CAPILLARY	15804042410	1
41	DRYER FILTER	16324020004	1
42	COOLING UNIT BOARD	GXE-2-001-0026-0	1
43	CONTROL PANEL UPPER HINGE	GXE-2-001-0030-0	1
44	PLASTIC WATER-PROOF BOX	16316130001	1
45	PLASTIC WATER-PROOF BOX COVER	16316130002	1
46	CONTROL PANER BOTTOM HINGE	GXE-2-001-0029-0	1
47	PANEL	GXE-0-000-0087-0	1
48	POWER SWITCH	17749210020	1
49	CONTROLLER	17709030002	1
50	DOOR LOCK	12546100952	1
51	WHEEL	12533110022	3
52	WHEEL(WITH LOCK)	12533110023	3
53	METAL FRAME(RIGHT)	GXE-0-000-0115-0	1
54	METAL FRAME(LEFT)	GXE-0-000-0116-0	1